

# CIVIL SITEWORK PLANS

## FOR

# TRIAD GOSLING RETAIL

### SPRING, TEXAS 77389

#### PLANS SUBMITTAL/REVIEW LOG

- PERMIT ISSUE 03/08/2019

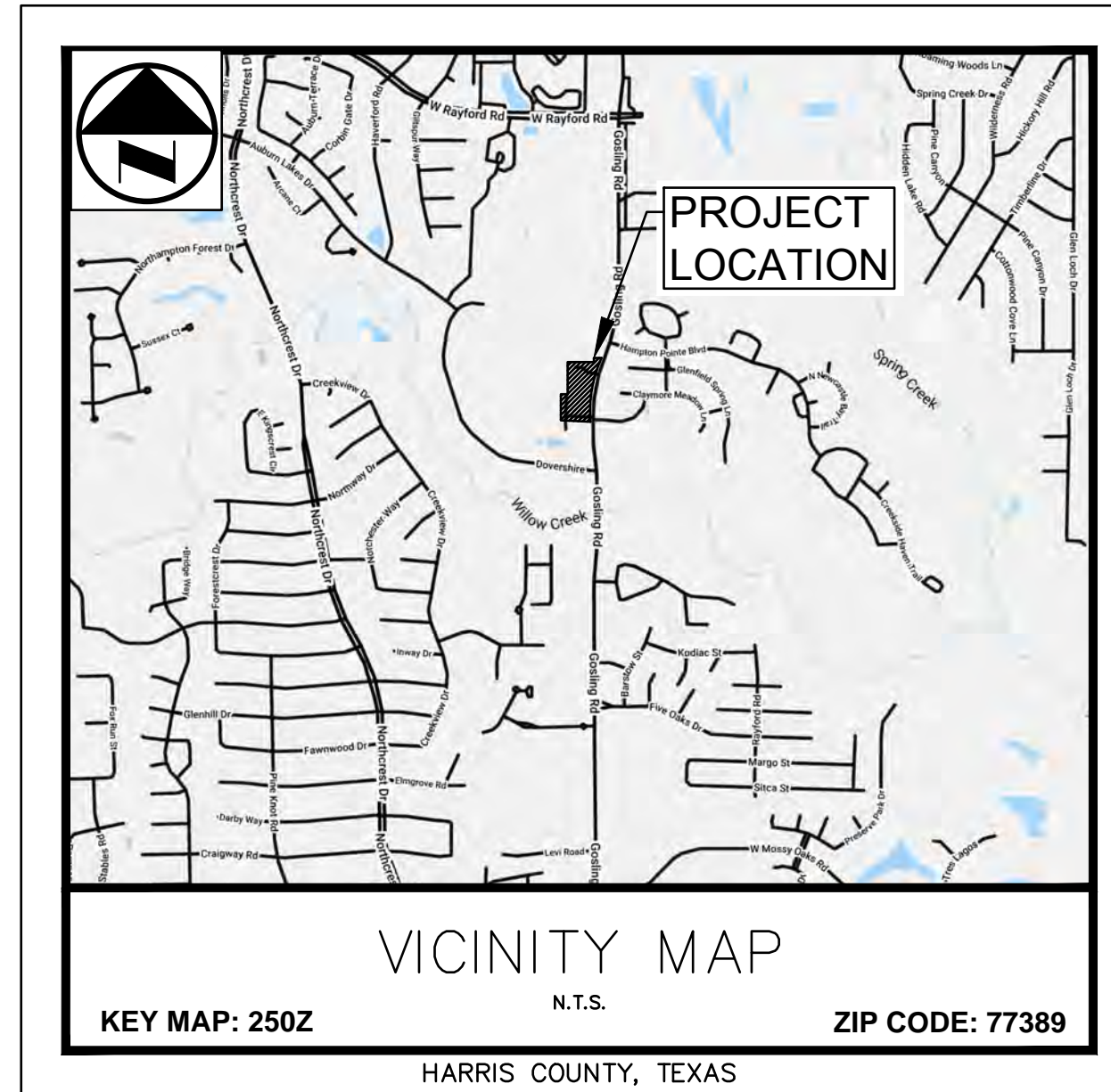

| INDEX OF SHEETS |                                    |
|-----------------|------------------------------------|
| Sheet Number    | Sheet Title                        |
| C0.0            | COVER SHEET                        |
| C0.1            | TOPOGRAPHIC SURVEY                 |
| C0.2            | PROPOSED PLAT (NOT INCLUDED)       |
| C0.3            | HARRIS COUNTY EXPRESS REVIEW SHEET |
| C1.0            | GENERAL NOTES                      |
| C2.0            | DEMOLITION PLAN                    |
| C3.0            | EROSION CONTROL PLAN               |
| C3.1            | EROSION CONTROL DETAILS            |
| C4.0            | DIMENSION CONTROL PLAN             |
| C5.0            | GRADING PLAN                       |
| C6.0            | PROPOSED DRAINAGE AREA MAP         |
| C7.0            | STORM SEWER PLAN                   |
| C8.0            | UTILITY PLAN                       |
| C9.0            | CONSTRUCTION DETAILS (1 OF 3)      |
| C9.1            | CONSTRUCTION DETAILS (2 OF 3)      |
| C9.2            | CONSTRUCTION DETAILS (3 OF 3)      |

AS PART OF THE BASE BID FOR THIS PROJECT, CONTRACTOR SHALL ADHERE TO THE PROJECT GEOTECHNICAL REPORT FOR ALL RECOMMENDATIONS FOR BOTH MATERIALS AND PRACTICE OF INSTALLATION GIVEN IN THE PROJECT GEOTECHNICAL REPORT FOR EARTHWORK, SITE SUBGRADE PREPARATION, BUILDING PAD SUBGRADE PREPARATION, PAVING, AND WET/SOFT SOILS CONDITIONS ALONG WITH ANY OTHER SECTIONS PROVIDED IN THE REPORT.

TITLE: RETAIL CENTER-GOSLING ROAD  
BY: ECS SOUTHWEST, LLP  
DATED: SEPTEMBER 12, 2018

INCLUDING ALL REVISIONS AND ADDENDA TO THIS REPORT THAT MAY HAVE BEEN RELEASED AFTER THE NOTED DATE.

REFERENCE BENCHMARKS

BENCHMARK - Elevation = 113.48' NAVD 1988, 2001 ADJUSTED  
FLOODPLAIN REFERENCE MARK NUMBER 120010 IS AN HCFCD BRASS DISK STAMPED WEISSER BM39 ON BRIDGE AT GOSLING AND WILLOW CREEK LOCATED ON DOWNS TREAM, EAST SHOULDER, AT CENTERLINE OF CREEK IN KEYMAP 290D IN THE WILLOW WATERSHED NEAR STREAM M100-00-00.

TEMPORARY BENCHMARK - Elevation = 111.26'  
RAILROAD SPIKE IN POWER POLE LOCATED AT THE SOUTHEASTERLY CORNER OF SUBJECT TRACT AS SHOWN HEREON.

OWNER:  
**TRIAD REAL ESTATE CONSULTING GROUP, LLC**  
3730 FM 1960 WEST, SUITE 300  
HOUSTON, TEXAS 77068

SURVEYOR:  
**HOVIS SURVEYING COMPANY**  
5000 CABBAGE  
SPRING, TEXAS 77379  
(281) 320-9591

PREPARED BY:

**Kimley»»Horn**

1400 Woodloch Forest Drive, Suite 225  
The Woodlands, Texas 77380  
Certificate of Authorization F-928  
Contact: STEVEN FREEMAN, P.E. Tel. No. (281)-475-2817

SHARED DETENTION POND NOTE:  
DETAILS OF SHARED DETENTION POND ARE SHOWN PER THE PLANS TITLED "CONSTRUCTION OF NORTH HAMPTON REGIONAL DETENTION FOR HARRIS COUNTY NORTH HAMPTON MUNICIPAL UTILITY DISTRICT", HARRIS COUNTY PROJECT NUMBER 1803130006. THE PROPOSED RETAIL SITE DEPICTED IN THESE PLANS MAY BE UNDER CONSTRUCTION CONCURRENTLY WITH THE SHARED DETENTION POND. GENERAL CONTRACTOR SHALL COORDINATE WITH NORTH HAMPTON MUD UTILITIES CONSTRUCTION CONTRACTOR REGULARLY TO ENSURE MEANS OF ACCESS TO THE SITE AND TIMING AND COORDINATION OF ALL CONNECTION POINTS BETWEEN THE TWO WORK AREAS. NOTIFY ENGINEER IMMEDIATELY OF ANY DISCREPANCIES BETWEEN THESE PLANS AND FIELD CONDITIONS.

PUBLIC UTILITIES NOTE:  
LOCATION OF EXISTING WATER AND SEWER LINES ADJACENT TO THIS SITE ARE SHOWN PER THE PRELIMINARY PLANS TITLED "PUBLIC WATER AND SANITARY SEWER EXTENSIONS TO SERVE TRIAD REAL ESTATE AND LANDMARK TRACT FOR NORTH HAMPTON MUNICIPAL UTILITY DISTRICT" BY JONES AND CARTER. AT THIS TIME, GOSLING ROAD IS BEING WIDENED AND THE PROPOSED RETAIL SITE DEPICTED IN THESE PLANS MAY BE UNDER CONSTRUCTION CONCURRENTLY WITH THE WATER AND SEWER LINES. GENERAL CONTRACTOR SHALL COORDINATE WITH NORTH HAMPTON MUD UTILITIES CONSTRUCTION CONTRACTOR REGULARLY TO ENSURE MEANS OF ACCESS TO THE SITE AND TIMING AND COORDINATION OF ALL CONNECTION POINTS BETWEEN THE TWO WORK AREAS. NOTIFY ENGINEER IMMEDIATELY OF ANY DISCREPANCIES BETWEEN THESE PLANS AND FIELD CONDITIONS.

GOSLING ROAD NOTE:  
LOCATION AND DIMENSIONS OF GOSLING ROAD ARE SHOWN PER THE PLANS OF HARRIS COUNTY PROJECT NUMBER 1701050019. AT THIS TIME, GOSLING ROAD IS BEING WIDENED AND THE PROPOSED RETAIL SITE DEPICTED IN THESE PLANS MAY BE UNDER CONSTRUCTION CONCURRENTLY. GENERAL CONTRACTOR SHALL COORDINATE WITH GOSLING ROAD CONSTRUCTION CONTRACTOR REGULARLY TO ENSURE MEANS OF ACCESS TO THE SITE AND TIMING AND COORDINATION OF ALL CONNECTION POINTS BETWEEN THE TWO WORK AREAS. NOTIFY ENGINEER IMMEDIATELY OF ANY DISCREPANCIES BETWEEN THESE PLANS AND FIELD CONDITIONS AT CONNECTION POINTS WITH GOSLING ROAD RIGHT-OF-WAY.

**811**  
Know what's below.  
Call before you dig.

**CAUTION!!**

EXISTING UNDERGROUND UTILITIES IN THE AREA CONTRACTOR IS RESPONSIBLE FOR DETERMINING THE HORIZONTAL AND VERTICAL LOCATION OF ALL UTILITIES PRIOR TO CONSTRUCTION. CONTRACTOR SHALL BE RESPONSIBLE FOR ANY REPAIRS TO EXISTING UTILITIES DUE TO DAMAGE INCURRED DURING CONSTRUCTION. CONTRACTOR SHALL NOTIFY THE ENGINEER OF ANY DISCREPANCIES ON THE PLANS.

| No. | REVISIONS | DATE | BY |
|-----|-----------|------|----|
|     |           |      |    |
|     |           |      |    |
|     |           |      |    |
|     |           |      |    |
|     |           |      |    |
|     |           |      |    |
|     |           |      |    |
|     |           |      |    |
|     |           |      |    |

**Kimley»»Horn**

© 2017 KIMLEY-HORN AND ASSOCIATES, INC.  
1400 WOODLOCH FOREST DRIVE, SUITE 225  
THE WOODLANDS, TEXAS 77380  
PHONE: 281-475-2817  
TBP# FIRM REGISTRATION F-928  
WWW.KIMLEY-HORN.COM

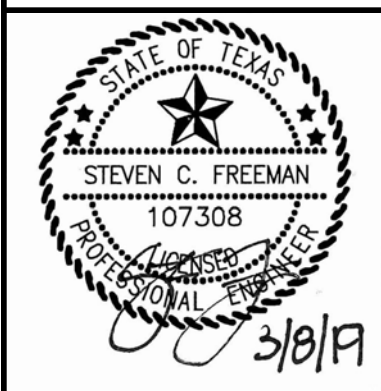

KHA PROJECT 067800501  
DATE 03/08/2019  
SCALE AS SHOWN  
DESIGNED BY SLH  
DRAWN BY MTL  
CHECKED BY SCF

**COVER SHEET**

TEXAS  
**TRIAD GOSLING RETAIL**  
HARRIS COUNTY

SHEET NUMBER  
**C0.0**