

Plotted By: Lanier, Morgan, Street, Set: KHA, Layout: 02.0, March 08, 2019, 02:28:52pm, K:\VLD\_Civil\067800501 - Triad Gosling Retail.DWG, PlanSheets\_C-Demo.dwg  
 This document, together with the concepts and designs presented herein, is intended only for the specific purpose and client for which it was prepared. Reuse or improper reliance on this document without written authorization and adaptation by Kimley-Horn and Associates, Inc. shall be without liability to Kimley-Horn and Associates, Inc.

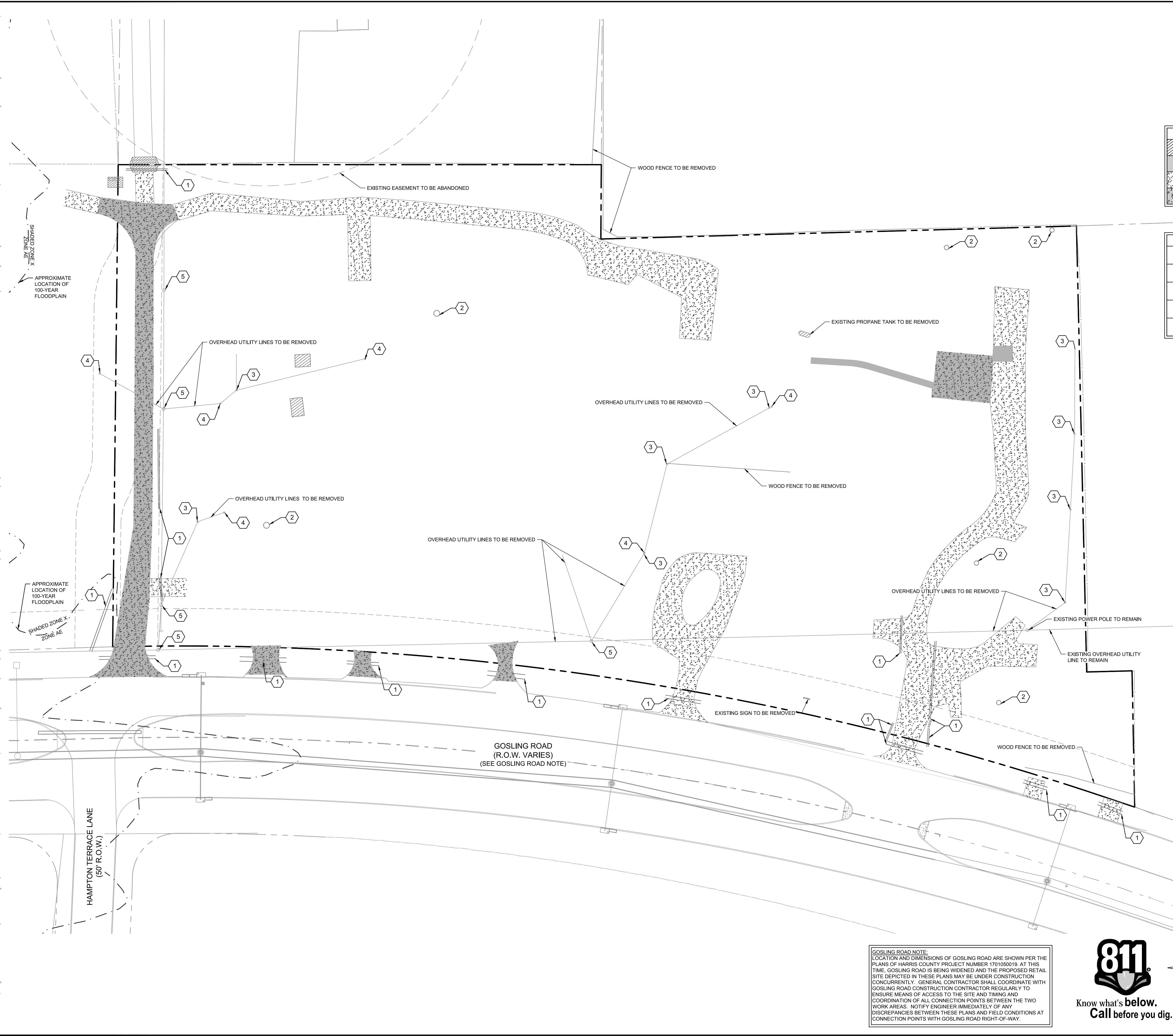

LEGEND	
	EXISTING BUILDING/STRUCTURE TO BE REMOVED
	EXISTING CONCRETE PAVEMENT TO BE REMOVED. CONTRACTOR TO REMOVE FULL DEPTH OF PAVEMENT.
	EXISTING GRAVEL TO BE REMOVED
	EXISTING ASPHALT TO BE REMOVED

KEYED NOTES	
①	EXISTING CULVERT TO BE REMOVED
②	EXISTING SSWR MANHOLE TO BE REMOVED
③	EXISTING SERVICE POLE TO BE REMOVED
④	EXISTING METER POLE TO BE REMOVED
⑤	EXISTING POWER POLE TO BE REMOVED

- GENERAL NOTES**
1. THE CONTRACTOR IS RESPONSIBLE FOR REMOVING ALL DEBRIS FROM THE SITE AND DISPOSING THE DEBRIS IN A LAWFUL MANNER. THE CONTRACTOR IS RESPONSIBLE FOR OBTAINING ALL PERMITS REQUIRED FOR DEMOLITION AND DISPOSAL.
  2. LOCATIONS OF PUBLIC AND PRIVATE UTILITIES SHOWN ARE APPROXIMATE AND MAY NOT BE COMPLETE. CONTRACTOR SHALL CALL 713-223-4567 AT LEAST 48 HOURS PRIOR TO COMMENCING DEMOLITION OR CONSTRUCTION ACTIVITIES. CONTRACTOR SHALL CONTACT ANY OTHER UTILITY COMPANIES WHO DO NOT SUBSCRIBE TO THE TEXAS ONE CALL PROGRAM FOR LINE MARKINGS. THE CONTRACTOR BEAR SOLE RESPONSIBILITY FOR VERIFYING LOCATIONS OF EXISTING UTILITIES, SHOWN OR NOT SHOWN, AND FOR ANY DAMAGES DONE TO THESE FACILITIES.
  3. ALL EXISTING UTILITIES SHOWN ARE LOCATED ACCORDING TO THE INFORMATION AVAILABLE TO THE ENGINEER AT THE TIME THE DRAWINGS ARE PREPARED AND HAVE NOT BEEN INDEPENDENTLY VERIFIED BY THE OWNER OR THE ENGINEER. GUARANTEE IS NOT MADE THAT ALL EXISTING UNDERGROUND UTILITIES ARE SHOWN OR THAT THE LOCATION OF THOSE SHOWN ARE ACCURATE. FINDING THE ACTUAL LOCATION OF ANY EXISTING UTILITIES IS THE CONTRACTOR'S RESPONSIBILITY AND SHALL BE DONE BEFORE HE COMMENCES ANY WORK. IN THE VICINITY. FURTHERMORE, THE CONTRACTOR SHALL BE SOLELY RESPONSIBLE FOR ANY AND ALL DAMAGE DUE TO THE CONTRACTOR'S FAILURE TO EXACTLY LOCATE AND PRESERVE ANY AND ALL UNDERGROUND UTILITIES. THE OWNER OR ENGINEER WILL ASSUME NO LIABILITY FOR ANY DAMAGES SUSTAINED OR COST INCURRED BECAUSE OF THE OPERATIONS IN THE VICINITY OF EXISTING UTILITIES OR STRUCTURES, NOR FOR TEMPORARY BRACING AND SHORING OF SAME. IF IT IS NECESSARY TO SHORE, BRACE, SWING OR RELOCATE A UTILITY, THE UTILITY COMPANY OR DEPARTMENT AFFECTED SHALL BE CONTACTED BY THE CONTRACTOR AND THEIR PERMISSION OBTAINED REGARDING THE METHOD TO USE FOR SUCH WORK.
  4. ANY DISCREPANCIES ON THE DRAWINGS SHALL BE IMMEDIATELY BROUGHT TO THE ATTENTION OF THE OWNER BEFORE COMMENCING WORK. NO FIELD CHANGES OR DEVIATIONS FROM DESIGN ARE TO BE MADE WITHOUT PRIOR APPROVAL OF THE OWNER AND NOTIFICATION TO THE ENGINEER. NO CONSIDERATION WILL BE GIVEN TO CHANGE ORDERS FOR WHICH THE OWNER AND ENGINEER WERE NOT CONTACTED PRIOR TO CONSTRUCTION OF THE AFFECTED ITEM.
  5. CONTRACTOR MUST PROTECT THE PUBLIC AT ALL TIMES WITH FENCING, BARRICADES, ENCLOSURES, ETC., TO THE BEST PRACTICES AND APPROVED BY THE OWNER.
  6. PRIOR TO DEMOLITION OCCURRING, ALL EROSION CONTROL DEVICES ARE TO BE INSTALLED PER THE PLANS.
  7. DAMAGE TO ALL EXISTING CONDITIONS TO REMAIN WILL BE REPLACED AT CONTRACTOR'S EXPENSE.
  8. ALL DEMOLITION WORK OR CONSTRUCTION VEHICLE TRAFFIC WITHIN 10 FEET OF THE CANOPY OF ANY TREE TO BE SAVED SHALL BE CLOSELY COORDINATED WITH TREE PRESERVATION ACTIVITIES.
  9. CONTRACTOR SHALL COMPLY TO THE FULLEST EXTENT WITH THE LATEST OSHA STANDARDS FOR EXCAVATION AND TRENCHING PROJECTS. CONTRACTOR SHALL USE SUPPORT SYSTEMS, SLOPING, BENCHING, ETC. AS NECESSARY FOR THESE OPERATIONS, AND SHALL COMPLY WITH ALL OSHA PERFORMANCE CRITERIA.
  10. CONTRACTOR TO REMOVE FULL DEPTH OF PAVEMENT (ASPHALT AND CONCRETE). REFERENCE SURVEY FOR LIMITS OF PAVEMENT.
  11. CONTRACTOR TO EPOXY ALL EXPOSED REBAR.
  12. CONTRACTOR IS RESPONSIBLE FOR MANAGING STORM WATER RUNOFF WITHIN THE PROJECT AREA DURING CONSTRUCTION, INCLUDING PROVIDING MEASURES FOR TEMPORARY CONVEYANCE OF FLOW WHICH MAY CONSIST OF DIVERSION SWALES OR PUMPING OF WATER TO EXISTING STORM OUTFALL LOCATIONS FROM PROJECT AREA TO MATCH EXISTING DRAINAGE PATTERNS PER THE EXISTING CONDITIONS DRAINAGE AREA MAP.
  13. CONTRACTOR SHALL SUBMIT A SEQUENCING/PHASING PLAN FOR THE PROPOSED STORM SEWER MODIFICATIONS IN THE SCOPE OF THIS PROJECT TO KIMLEY-HORN FOR REVIEW PRIOR TO COMMENCING CONSTRUCTION. THE STORM SEWER SEQUENCING/PHASING PLAN SHALL INCLUDE THE PROPOSED MEASURES TO BE IMPLEMENTED BY CONTRACTOR FOR MANAGING STORM WATER RUNOFF WITHIN THE PROJECT AREA DURING CONSTRUCTION TO ENSURE RUNOFF IS ROUTED TO MATCH THE EXISTING DRAINAGE PATTERNS.

**GOSLING ROAD NOTE:**  
 LOCATION AND DIMENSIONS OF GOSLING ROAD ARE SHOWN PER THE PLANS OF HARRIS COUNTY PROJECT NUMBER 70105019. AT THIS TIME, GOSLING ROAD IS BEING WIDENED AND THE PROPOSED RETAIL SITE DEPICTED IN THESE PLANS MAY BE UNDER CONSTRUCTION CONCURRENTLY. GENERAL CONTRACTOR SHALL COORDINATE WITH GOSLING ROAD CONSTRUCTION CONTRACTOR REGULARLY TO ENSURE MEANS OF ACCESS TO THE SITE AND TIMING AND COORDINATION OF ALL CONNECTION POINTS BETWEEN THE TWO WORK AREAS. NOTIFY ENGINEER IMMEDIATELY OF ANY DISCREPANCIES BETWEEN THESE PLANS AND FIELD CONDITIONS AT CONNECTION POINTS WITH GOSLING ROAD RIGHT-OF-WAY.



**CAUTION!!**  
 EXISTING UNDERGROUND UTILITIES IN THE AREA CONTRACTOR IS RESPONSIBLE FOR DETERMINING THE HORIZONTAL AND VERTICAL LOCATION OF. ALL UTILITIES PRIOR TO CONSTRUCTION. CONTRACTOR SHALL BE RESPONSIBLE FOR ANY REPAIRS TO EXISTING UTILITIES DUE TO DAMAGE INCURRED DURING CONSTRUCTION. CONTRACTOR SHALL NOTIFY THE ENGINEER OF ANY DISCREPANCIES ON THE PLANS.

 © 2017 KIMLEY-HORN AND ASSOCIATES, INC. 1400 WOODLICK FOREST DRIVE, SUITE 225 THE WOODS, TEXAS 75075-2216 PHONE: 281.241.2416 WWW.KIMLEY-HORN.COM		REVISIONS	DATE
		No.	
KHA PROJECT: 067800501 DATE: 03/08/2019 SCALE: AS SHOWN DESIGNED BY: SLH DRAWN BY: MTL CHECKED BY: SCF		<b>DEMOLITION PLAN</b>  TEXAS	
<b>TRIAD GOSLING RETAIL</b> HARRIS COUNTY			