

Plotted By: Lanier, Morgan. Sheet Set: KHA. Layout: C3.0. March 08, 2019. 02:29:04pm. K:\VMD\Civil\067800501 - Triad Gosling Retail\DWG\PlanSheets\C3-Erosion.dwg
 This document, together with the concepts and designs presented herein, is intended only for the specific purpose and client for which it was prepared. Reuse or improper reliance on this document without written authorization and adaptation by Kimley-Horn and Associates, Inc. shall be without liability to Kimley-Horn and Associates, Inc.

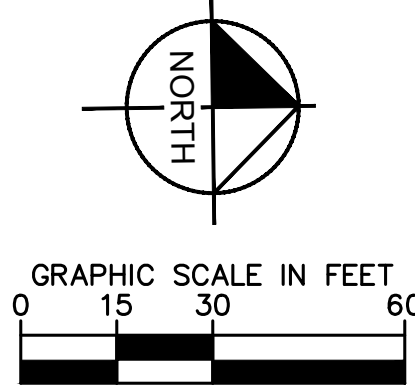
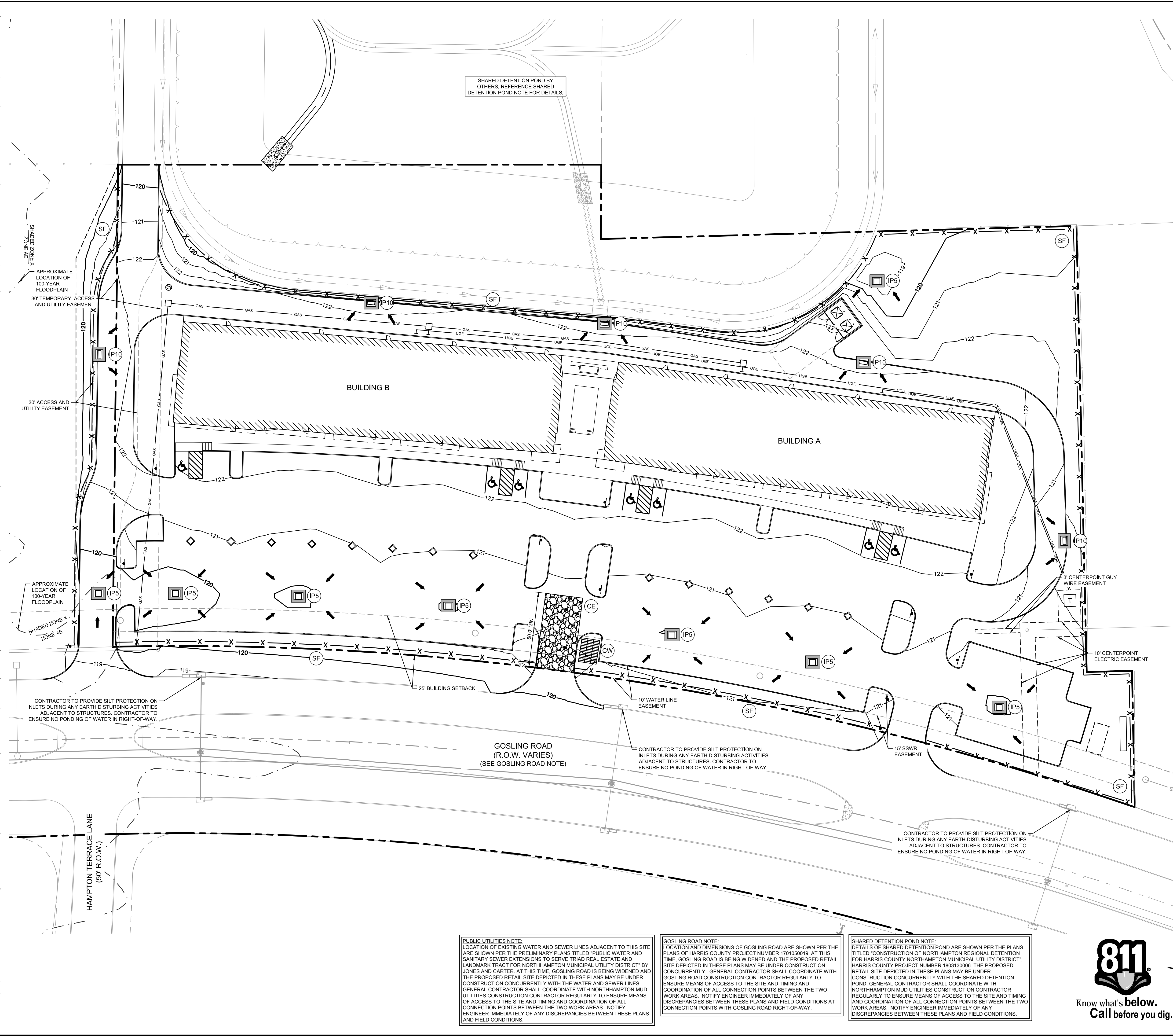

SHARED DETENTION POND BY OTHERS. REFERENCE SHARED DETENTION POND NOTE FOR DETAILS.

- EROSION CONTROL NOTES**
- CONTRACTOR IS SOLELY RESPONSIBLE FOR SELECTION, IMPLEMENTATION, MAINTENANCE, AND EFFECTIVENESS OF ALL SWPPP CONTROLS - CONTROLS SHOWN ON THIS SITE MAP ARE SUGGESTED CONTROLS ONLY.
 - CONTRACTOR SHALL RECORD INSTALLATION, MAINTENANCE OR MODIFICATION, AND REMOVAL DATES FOR EACH BMP EMPLOYED (WHETHER CALLED OUT ON ORIGINAL SWPPP OR NOT) DIRECTLY ON THIS SITE MAP.
 - DRAINAGE PATTERNS ARE SHOWN ON THIS PLAN BY PROPOSED AND EXISTING CONTOURS.
 - TEMPORARY AND PERMANENT STABILIZATION PRACTICES AND BMP'S SHALL BE INSTALLED AT THE EARLIEST POSSIBLE TIME DURING THE CONSTRUCTION SEQUENCE. AS AN EXAMPLE, PERIMETER SILT FENCE SHALL BE INSTALLED BEFORE COMMENCEMENT OF ANY GRADING ACTIVITIES. OTHER BMP'S SHALL BE INSTALLED AS SOON AS PRACTICABLE AND SHALL BE MAINTAINED UNTIL FINAL SITE STABILIZATION IS ATTAINED. CONTRACTOR SHALL ALSO REFERENCE CIVIL PLANS SINCE PERMANENT STABILIZATION IS PROVIDED BY LANDSCAPING AND SITE PAVING.
 - BMP'S HAVE BEEN LOCATED AS INDICATED ON THIS PLAN IN ACCORDANCE WITH GENERALLY ACCEPTED ENGINEERING PRACTICES IN ORDER TO MINIMIZE SEDIMENT TRANSFER. FOR EXAMPLE, SILT FENCES LOCATED AT TOE OF SLOPE AND INLET PROTECTION FOR INLETS RECEIVING SEDIMENT FROM SITE RUN-OFF.
 - SANITARY SEWER EFFLUENT IS DISPOSED OF VIA AN ONSITE SEWER SYSTEM CONNECTED TO A MUNICIPAL SEWER SYSTEM.
 - CONTRACTOR TO PROVIDE INLET PROTECTION IN PUBLIC ROW ONLY DURING EARTH MOVING ACTIVITIES. CONTRACTOR TO ENSURE PONDING DOES NOT OCCUR IN PUBLIC ROW OR ON ADJACENT PROPERTIES AT ANY TIME DURING CONSTRUCTION.
 - CONSTRUCTION ENTRANCE SHALL BE LOCATED SO AS TO PROVIDE THE LEAST AMOUNT OF DISTURBANCE TO THE FLOW OF TRAFFIC IN AND OUT OF THE SITE. ADDITIONALLY, THE CONSTRUCTION ENTRANCE SHALL BE LOCATED TO COINCIDE WITH THE PHASING OF THE PARKING LOT CONSTRUCTION.
 - CONTRACTOR SHALL PROVIDE INLET PROTECTION FOR ANY AFFECTED INLETS DOWNSTREAM OF THE PROPOSED IMPROVEMENTS, IF NEEDED.
 - THE NATURE OF THIS SITE'S CONSTRUCTION CONSISTS OF CLEARING & SITE PREPARATION, EARTHWORK, PAVING AND LANDSCAPING.
 - SEDIMENTATION BASIN: NEITHER A TEMPORARY NOR PERMANENT SEDIMENTATION BASIN HAS BEEN PROVIDED ON THIS SITE BECAUSE THE SITE IS LESS THAN 10 ACRES IN AREA.
 - POST CONSTRUCTION STORM WATER POLLUTION CONTROL MEASURES INCLUDE STABILIZATION BY PERMANENT PAVING AND LANDSCAPING.
 - DISTURBED PORTIONS OF SITE MUST BE STABILIZED. STABILIZATION PRACTICES MUST BE INITIATED WITHIN 14 DAYS IN PORTIONS OF THE SITE WHERE CONSTRUCTION HAS BEEN EITHER TEMPORARILY OR PERMANENTLY CEASED, UNLESS EXCEPTED WITHIN THE OPDES PERMIT. CONTRACTOR SHALL REMOVE TEMPORARY EROSION CONTROL DEVICES UPON COMPLETION OF STABILIZATION.
 - CONTRACTOR IS RESPONSIBLE FOR MODIFYING THE SWPPP/SITE MAP TO INCLUDE BMP'S FOR ANY OFF-SITE MATERIAL WASTE, BORROW OR EQUIPMENT STORAGE AREAS.
 - CONTRACTOR IS RESPONSIBLE FOR SUBMITTAL OF NOI, NOT, POSTING OF SITE NOTICES, AND ANY ADDITIONAL INFORMATION OR SUBMITTALS REQUIRED BY TCEQ, EPA, OR LOCAL JURISDICTION.
 - CONTRACTOR TO MAINTAIN NO MORE THAN 10 ACRES OF DRAINAGE TO ANY SINGLE OUTFALL LOCATION DURING CONSTRUCTION.

| LEGEND | |
|-----------------|--|
| 121 | PROPOSED CONTOUR ELEVATIONS |
| EROSION DETAILS | |
| IP5 | FILTER SACK INLET PROTECTION (SEE DETAIL C3.1) |
| IP10 | CURB INLET PROTECTION (SEE DETAIL C3.1) |
| SF | SILT FENCE (SEE DETAIL C3.1) |
| CE | CONSTRUCTION ENTRANCE (SEE DETAIL C3.1) |
| CW | CONCRETE WASHOUT (SEE DETAIL C3.1) |
| → | PROJECTED FLOW DIRECTION |

SWPPP NOTE

ANY OFF-SITE STAGING AREA UTILIZED BY THE OPERATOR OF THIS SITE MUST BE INCLUDED IN THE SWPPP NARRATIVE PLAN AND TO SWPPP SITE PLAN AS REQUIRED BY THE TPDES TEXAS GENERAL PERMIT (XR180000) (SECTION F). ANY SUCH AREA INCLUDED IN THE SWPPP WILL BE TREATED BY THE OPERATOR AS ANY OTHER PART OF THE CONSTRUCTION ACTIVITY FOR THE PURPOSES OF STORM WATER POLLUTION PREVENTION.

CAUTION!!

EXISTING UNDERGROUND UTILITIES IN THE AREA. CONTRACTOR IS RESPONSIBLE FOR DETERMINING THE HORIZONTAL AND VERTICAL LOCATION OF ALL UTILITIES PRIOR TO CONSTRUCTION. CONTRACTOR SHALL BE RESPONSIBLE FOR ANY REPAIRS TO EXISTING UTILITIES DUE TO DAMAGE INCURRED DURING CONSTRUCTION. CONTRACTOR SHALL NOTIFY THE ENGINEER OF ANY DISCREPANCIES ON THE PLANS.

PUBLIC UTILITIES NOTE

LOCATION OF EXISTING WATER AND SEWER LINES ADJACENT TO THIS SITE ARE SHOWN PER THE PRELIMINARY PLANS TITLED "PUBLIC WATER AND SANITARY SEWER EXTENSIONS TO SERVE TRIAD REAL ESTATE AND LANDMARK TRACT FOR NORTH HAMPTON MUNICIPAL UTILITY DISTRICT" BY JONES AND CARTER. AT THIS TIME, GOSLING ROAD IS BEING WIDENED AND THE PROPOSED RETAIL SITE DEPICTED IN THESE PLANS MAY BE UNDER CONSTRUCTION CONCURRENTLY WITH THE WATER AND SEWER LINES. GENERAL CONTRACTOR SHALL COORDINATE WITH NORTH HAMPTON MUD UTILITIES CONSTRUCTION CONTRACTOR REGULARLY TO ENSURE MEANS OF ACCESS TO THE SITE AND TIMING AND COORDINATION OF ALL CONNECTION POINTS BETWEEN THE TWO WORK AREAS. NOTIFY ENGINEER IMMEDIATELY OF ANY DISCREPANCIES BETWEEN THESE PLANS AND FIELD CONDITIONS.

GOSLING ROAD NOTE

LOCATION AND DIMENSIONS OF GOSLING ROAD ARE SHOWN PER THE PLANS OF HARRIS COUNTY PROJECT NUMBER 1701050019. AT THIS TIME, GOSLING ROAD IS BEING WIDENED AND THE PROPOSED RETAIL SITE DEPICTED IN THESE PLANS MAY BE UNDER CONSTRUCTION CONCURRENTLY. GENERAL CONTRACTOR SHALL COORDINATE WITH GOSLING ROAD CONSTRUCTION CONTRACTOR REGULARLY TO ENSURE MEANS OF ACCESS TO THE SITE AND TIMING AND COORDINATION OF ALL CONNECTION POINTS BETWEEN THE TWO WORK AREAS. NOTIFY ENGINEER IMMEDIATELY OF ANY DISCREPANCIES BETWEEN THESE PLANS AND FIELD CONDITIONS.

SHARED DETENTION POND NOTE

DETAILS OF SHARED DETENTION POND ARE SHOWN PER THE PLANS TITLED "CONSTRUCTION OF NORTH HAMPTON REGIONAL DETENTION FOR HARRIS COUNTY NORTH HAMPTON MUNICIPAL UTILITY DISTRICT". HARRIS COUNTY PROJECT NUMBER 1803130009. THE PROPOSED RETAIL SITE DEPICTED IN THESE PLANS MAY BE UNDER CONSTRUCTION CONCURRENTLY WITH THE SHARED DETENTION POND. GENERAL CONTRACTOR SHALL COORDINATE WITH NORTH HAMPTON MUD UTILITIES CONSTRUCTION CONTRACTOR REGULARLY TO ENSURE MEANS OF ACCESS TO THE SITE AND TIMING AND COORDINATION OF ALL CONNECTION POINTS BETWEEN THE TWO WORK AREAS. NOTIFY ENGINEER IMMEDIATELY OF ANY DISCREPANCIES BETWEEN THESE PLANS AND FIELD CONDITIONS.



REVISIONS

| No. | DATE | BY |
|-----|------|----|
| | | |

© 2017 KIMLEY-HORN AND ASSOCIATES, INC.
 1400 WOODLICK FOREST DRIVE, SUITE 225
 THE WOODS, TEXAS 75069-2416
 PHONE: 281.271.2416
 FAX: 281.271.2416
 WWW.KIMLEY-HORN.COM

DATE

RHA PROJECT
067800501

DATE
03/08/2019

SCALE AS SHOWN

DESIGNED BY
SLH

DRAWN BY
MITL

CHECKED BY
SCF

EROSION CONTROL PLAN

TRIAD GOSLING RETAIL
HARRIS COUNTY

TEXAS

SHEET NUMBER
C3.0